

The Bystronic logo is a red square with the word "Bystronic" in white. The letter "y" is stylized with a white dot grid pattern.

Bystronic

Best choice.

COLLECTION SOFTWARE

A large teal rectangular block occupies the bottom half of the page. In the bottom right corner of this block, the binary code "10101", "00110", and "11001" is written in white.

**10101
00110
11001**

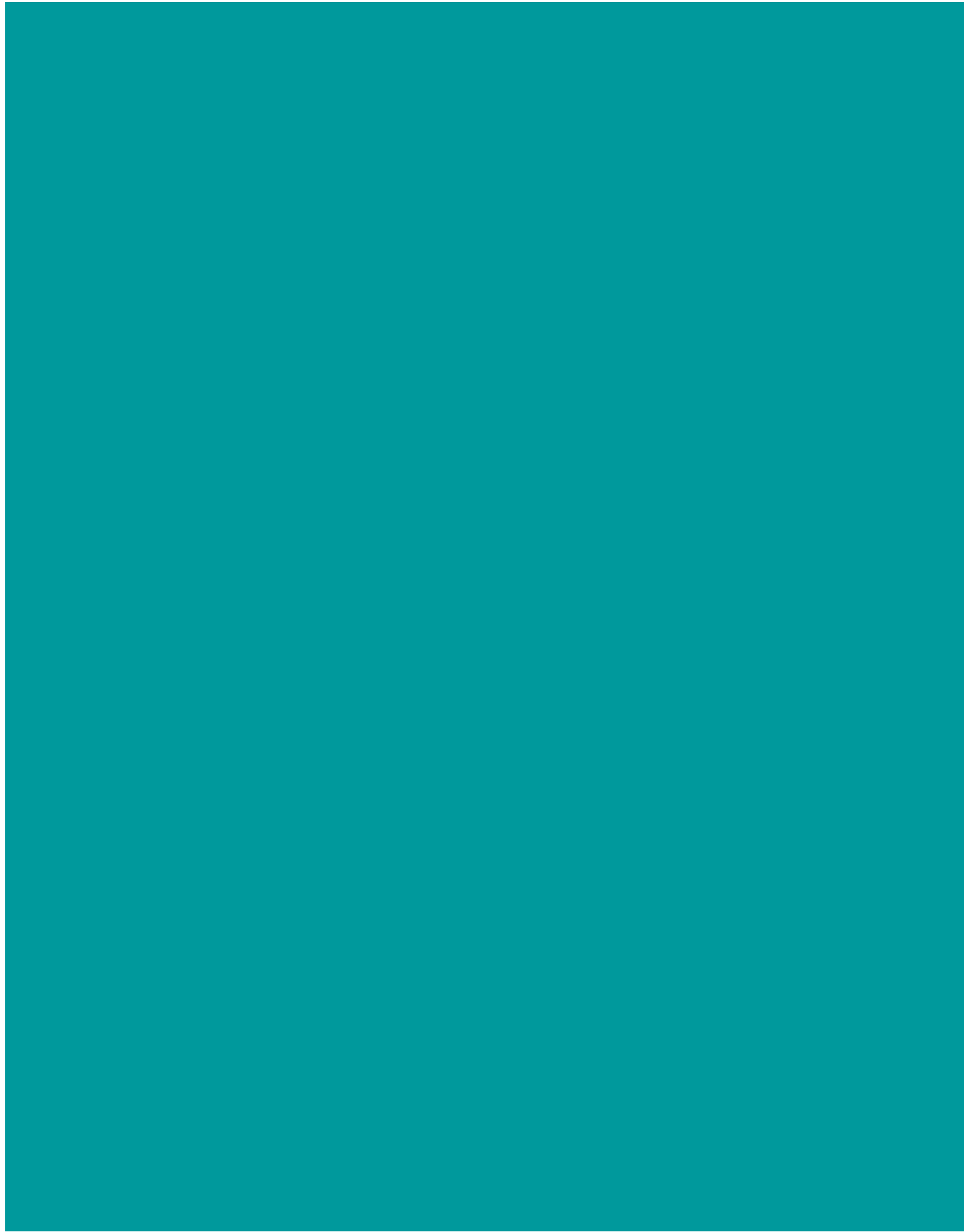

A large, stylized, 3D red number 7 is the central focus of the image. The number is composed of a thick horizontal bar at the top and a diagonal stem extending from the bottom-left of the bar towards the bottom-right of the frame. The 3D effect is achieved through shading: the top surface of the horizontal bar and the front face of the diagonal stem are a bright red, while the side faces are a slightly darker shade of red. The text 'BySoft 7' is positioned on the right side of the top horizontal bar, rendered in a white, bold, sans-serif font.

BySoft 7



BySoft 7

Construct and calculate parts, create cutting plans and bending programs, plan and monitor manufacturing processes: Modern sheet metal manufacturing is no longer imaginable without powerful software like BySoft 7. BySoft 7 offers comprehensive functionality, while remaining easy to use. This way, you maintain an overview, while completing jobs quickly, affordably, and reliably. BySoft 7 – Make it easy.

Construct Parts

BySoft 7 supports your parts construction with powerful 3D-CAD, widely distributed across the world. BySoft 7 provides exactly those tools you need for a specific situation, communicates a clear idea of the immediate status of the model, and is intuitive to use. Thus, you quickly and confidently achieve correct 3D models of the parts to be manufactured.

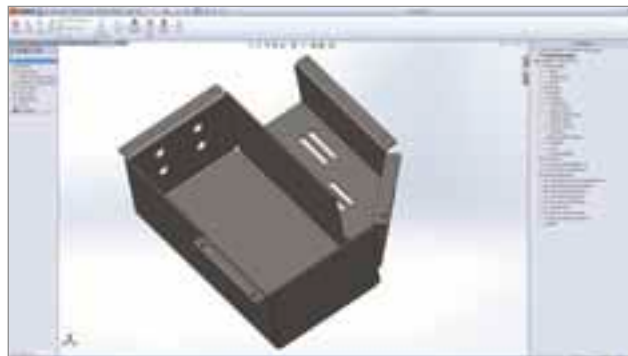

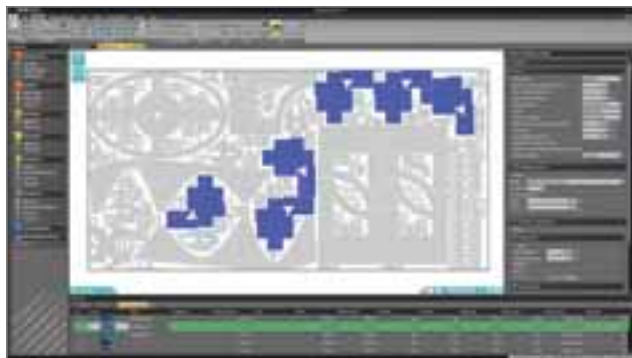

Create Cutting Plans

BySoft 7 automatically ensures that sheet metal, tubes, and profiles are used completely and nests as many parts as technically possible. To do this, BySoft 7 has countless functions, for example, various nesting processes. What's more, BySoft 7 optimizes your cutting processes and automatically selects each optimal cutting technology.

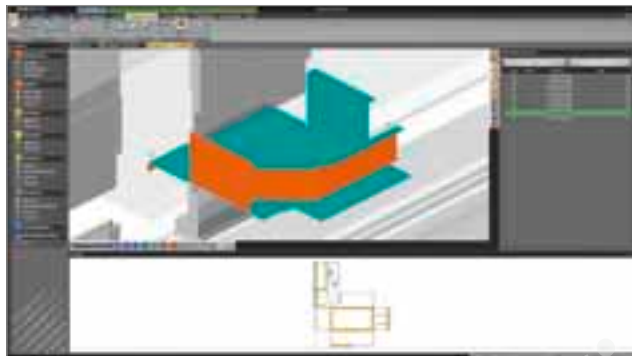

Create Bending Programs

With BySoft 7, you can create perfect bending programs. Bending sequence, backgauge position, and tool plan are detected automatically so that the bending process can start more quickly. Furthermore, BySoft 7 simulates the bending sequence and displays possible collisions automatically. This ensures safety, saves even more time and material, and shortens job throughput times.



Plan and Monitor Manufacturing Processes

Thanks to BySoft 7, cutting and bending jobs are completed quickly and with little effort. Because: You maintain an overview of your manufacturing processes and make informed decisions. Thus, you deliver on time and with favorable conditions. Furthermore, BySoft 7 automatically plans, initiates, and monitors part production and offers immediate access to all relevant production and machine data. This is how BySoft 7 guarantees maximum transparency.

Requirements and solutions

BySoft 7 consists of four individual modules

- 2D Processing
- Bending
- Tube Processing
- Plant Manager

Depending on need, the modules can be purchased either individually, in personal combinations, or as a complete package.

How is BySoft 7 integrated into the existing IT environment?

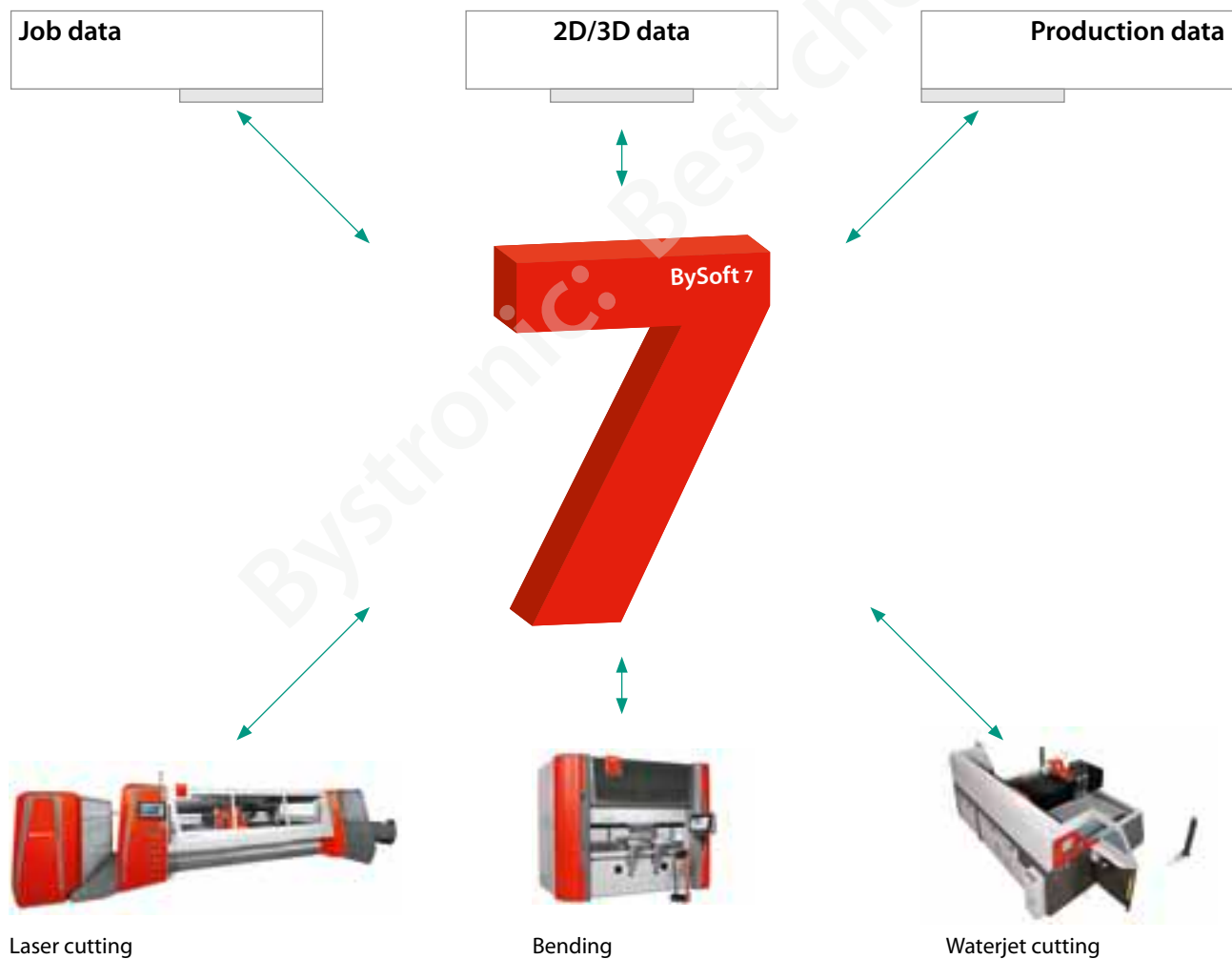

Which options do the individual modules offer?

Function	2D Processing	Bending	Tube Processing	Plant Manager		
				Planning	Production	Statistics
2D/3D-CAD Standard	●	●	●			
Bending Sequence Simulation		●				
Bending Technology		●				
ByVision Visualization					●	
CAD Bending Functions		●				
CAD Tube Functions			●			
NEW Calculate part costs	●	●	●	●		
Cutting Simulation	●		●			
Cutting Technology	●		●			
Cutting Time Calculation	●		●			
Bending Programs Export		●				
Cutting Programs Export	●		●			
Production Data Export				●		
Cutting Plans Management				●		
Automatic Cutting Plan Packaging				●		
Machine Utilization				●		
Notification Service				●	●	●
Automatic Job Import				●		
Job Management				●		
Parts Import	●	●	●			
Parts Management				●		
NEW PartID (part identification)*	●			●		
Parts Nesting	●		●			
NEW Bevel Manager (beveled cutting edges)*	●					
Production Monitoring					●	
NEW Parts removal					●	
Quick Support	●	●	●			
Employment Papers	●	●	●	●		
Planning				●		
Production					●	
Statistics						●

* = Option

How can the individual modules be combined?

Module	Combinations												
	01	02	03	04	05	06	07	08	09	10	11	12	13
2D Processing	●			●	●	●	■				■	■	■
Bending		●		●		●							
Tube Processing			●		●	●							
Plant Manager Planning	●										●	●	●
Plant Manager Production		●								●	●		●
Plant Manager Statistics									●	●		●	●

■ The 2D processing module is included in the Plant Manager Planning module



2D Processing

With this module, you can construct parts and import and edit existing CAD data. You can create perfect cutting plans for processing sheet metal and other 2D materials

Customer benefits

- Thanks to BySoft 7, you can construct parts with powerful and worldwide distributed 2D and 3D CAD
- You can create cutting programs in next to no time because BySoft 7 is clearly structured and turns less practiced users into programming professionals
- You will reduce part costs because raw material is used completely. To do so, BySoft 7 has comprehensive options, for example, various nesting processes
- With the touch of a button, BySoft 7 always selects the correct cutting technology and implements it with ease
- Thanks to countless functions, BySoft 7 provides reliable processes. You profit thanks to perfectly cut parts and a high machine usage rate

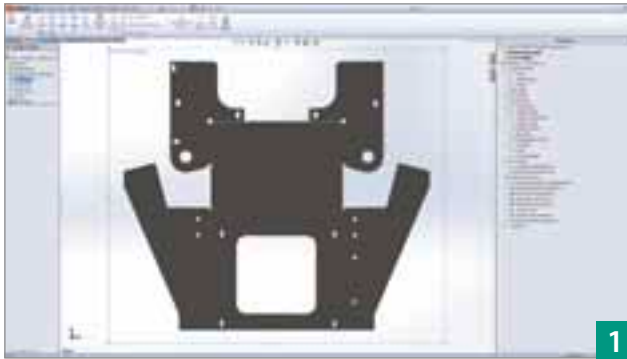

1 Parts Construction

2 Parts Nesting

3 Residual sheet and other miscellaneous shapes can (4) be used as raw material





Bending

With this module, you can model parts and import and edit existing CAD data. You can create perfect unfolding and bending programs

Customer benefits

- Thanks to BySoft 7, you can construct parts with powerful and worldwide distributed 2D and 3D CAD
- You can use your pressbrake capacity in its entirety because parts are no longer programmed on the machine, but rather by BySoft 7
- All relevant machine and tool data for your pressbrake(s) are stored in BySoft 7. Thus, you achieve perfect unfolding. The bend allowance values were determined empirically by experts
- Thanks to full simulation of bending sequences, you can prevent collisions and costly errors
- You can prepare jobs more quickly because BySoft 7 determines and suggests bending sequences, backgauge positions, and tool plans

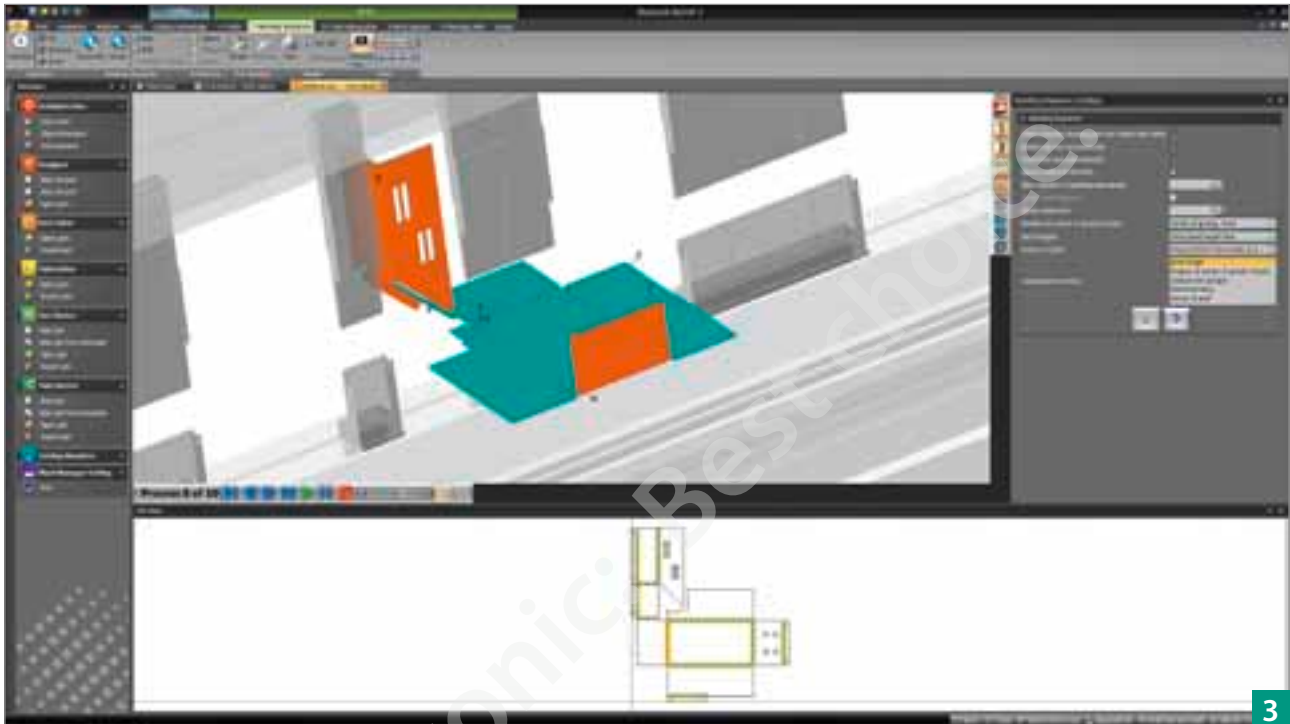
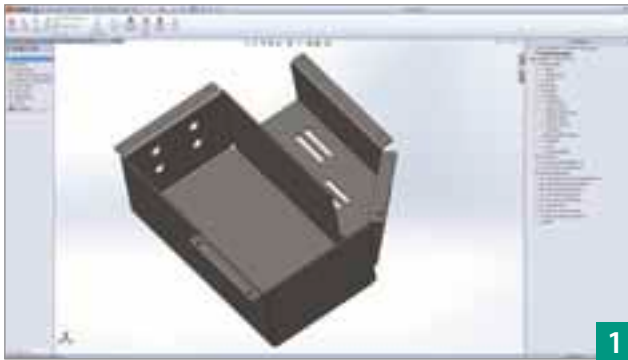

- 1 3D Parts Construction
- 2 3D Data Executed Perfectly
- 3 Calculation and Simulation of Bending Sequence
- 4 Calculation of Tool and Set-Up Plan



Tube Processing

With this module, you can construct parts and import and edit existing CAD data. You can create perfect cutting plans for processing tubes and profiles

Customer benefits

- Thanks to BySoft 7, you can construct parts with powerful and worldwide distributed 2D and 3D CAD
- Even complex tube and profile cutting programs can be created in the blink of an eye. Because: BySoft 7 is clearly structured and turns less practiced users into programming professionals
- By turning sections and parts, these can be nested with even more efficiency. Raw material is used completely and part costs are further reduced
- With the touch of a button, BySoft 7 always selects the correct cutting technology and implements it with ease
- Thanks to countless functions, BySoft 7 provides reliable processes. You profit thanks to perfectly cut parts and a high machine usage rate

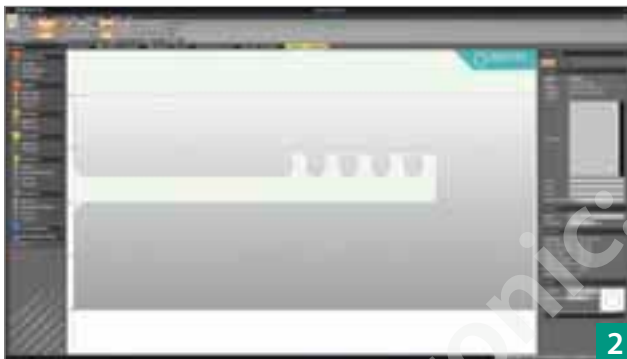
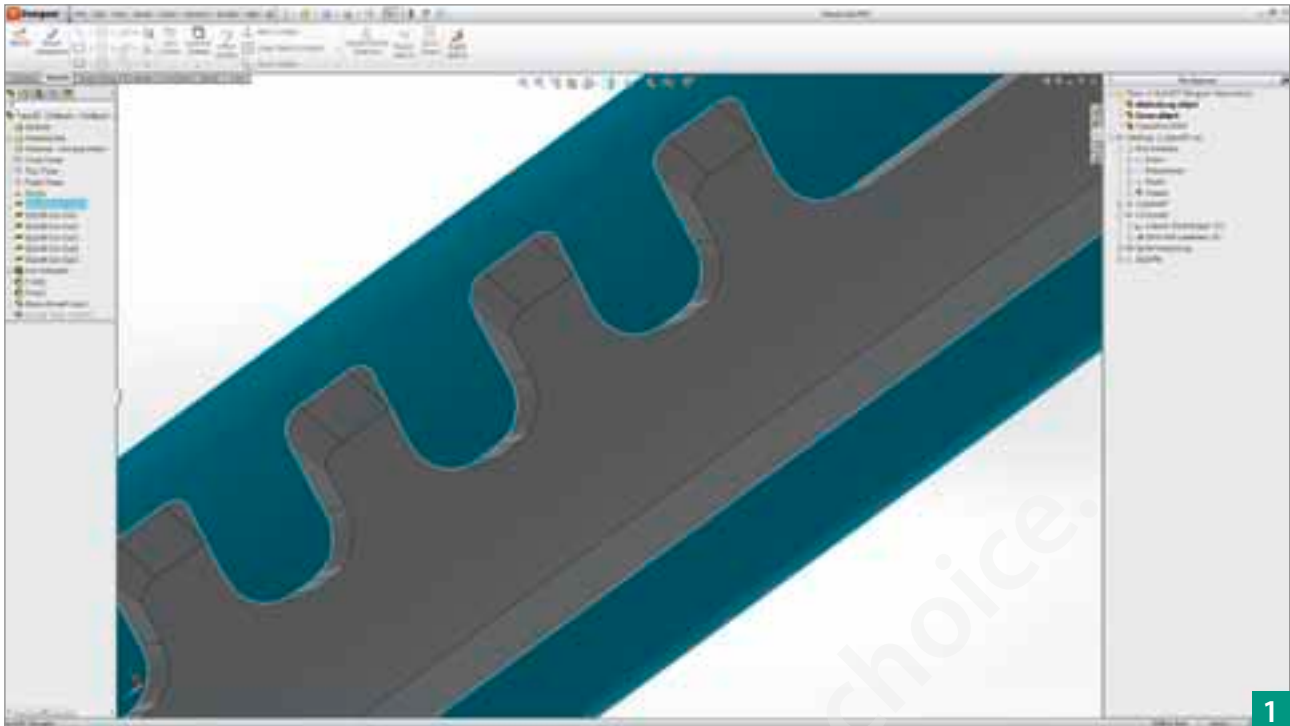

- 1 Easy Parts Construction
- 2 Unfolding 3D Data
- 3 Nesting with Shared Cut Lines



Plant Manager

The Plant Manager plans and monitors manufacturing processes. It provides maximum transparency for sheet processing

What is the Plant Manager?

The Plant Manager is a unique tool with which you can plan and monitor all laser and waterjet cutting processes in both an **automatic** and **informed** way.

Which tasks does the Plant Manager assume?

Each ERP system is subdivided into individual work cycles in the production chain. One of these cycles is the general planning of cutting processes. Here, the Plant Manager assesses and refines the planning automatically. In this way, individual steps and time are saved, costs are reduced, and error sources are eliminated. Furthermore, the Plant Manager initiates and monitors parts production and provides you with comprehensive statistical data.

Planning



- The Plant Manager draws job data from the ERP system or other job sources and links them with the CAD data
- It creates optimal cutting plans and applies the suitable cutting technology
- The Plant Manager groups parts according to type of material, material thickness, and schedule, as well as according to cutting head and cutting nozzle

Production



- The Plant Manager manages and controls all machine jobs, including your express jobs
- It plans for maintenance windows and shifts
- The Plant Manager monitors and visualizes the processes on the individual machine systems and the condition of these systems
- It delivers a complete production overview

Statistics



- The Plant Manager assesses all relevant machine and job data for you and provides you with the corresponding statistics
- If a defined event takes place, the Plant Manager will send you a corresponding email

Customer benefits

- You can manufacture parts more quickly, at a lower cost, and with less effort
- Your processes will run more reliably because manual entries are no longer necessary and machines are regularly maintained
- You retain a complete overview of your production and the condition of your machine systems
- You receive data with which you can further increase your production efficiency

Other software products

Bystronic also offers other software products, independently of BySoft 7, for monitoring, controlling, and optimizing your manufacturing processes

10101
00110
11001

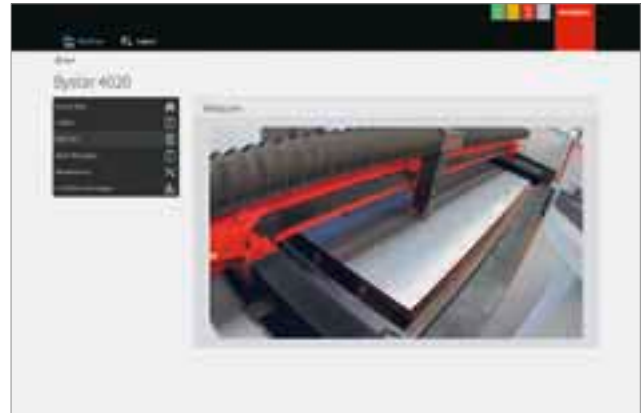
**NEW**

Observer

Observer is a web-based and camera-supported remote monitoring tool for laser and waterjet cutting machines that enables you to optimize your production processes and lower your manufacturing costs

Customer benefits

- Increased machine availability, thanks to early idle state recognition
- Increased functional reliability with location-independent machine state information
- Optimized production costs due to decreased deviation from planned production time

Bystronic Collections



Image brochure

Tool catalog

Not all products listed in this brochure are available in all countries.

This brochure may show parts that are not standard equipment, but are available as options. For the better visibility of machine details, some safety covers may have been opened or removed for these pictures. The right to make changes to dimensions, construction and equipment is reserved.

ISO-9001-certified

The Bystronic logo consists of the word "Bystronic" in white, bold, sans-serif font, positioned in the upper left corner of a solid red square. A small, white, diamond-shaped graphic with a grid pattern is located to the right of the text.

Bystronic

Best choice.

COLLECTION SOFTWARE

bystronic.com

**10101
00110
11001**